



20 YEARS
OF
MANUFACTURING AND
EXPORTING LPG AND CNG
KIT PARTS



**LPG/CNG
PRODUCT CATALOGUE**

**CATALOGUE DE PRODUCTOS
GPL/GNV**



ABOUT US

Clean Enviro Fuels Pvt. Ltd., established in 2007, is one of the leading manufacturers of LPG & CNG Kits in India. The company produces Kits and components under their own brand names LOWGAS, LOVAGAS FHT, ZOOM, SMITH, OLA-GAS, BERGINI and also undertake OEM Branding of products for many customers worldwide. The brands have a good reputation and presence in the world market and respected for reliable product performance.

The company is one of major producers of LPG and CNG Kits, LPG Vaporizer, CNG Reducer, Solenoid Valves, Filling Valves, Multi Function Valves in India, with commercial presence in over 20 countries across the world. Apart from its own manufacturing, the company is also engaged in trading of high quality Electronic control units made by AEB Italy, AC STAG Poland.

MANAGEMENT

The company is promoted by Mr. Jogesh Verma, BE (Production) & PGDMM by qualification and has worked in various industries before venturing in LPG/CNG business way back in 1999.

VISION

To be the one of the best sourcing destinations for Alternative Fuel Products in INDIA through the excellence of its people, its innovative approach and overall conduct. Underpinning this vision is a performance culture committed to aspiration targets, safety and social responsibility, continuous improvement, openness, and transparency.

OUR PRESENCE



OUR BRANDS



APPROVALS / CERTIFICATION





CNG KIT-CARS



CNG SEQUENTIAL KIT 4C-32

- CNG Reducer Model S9000/S8000/S7000
- CNG High Pressure Steel Pipe 6mm x 5.5 mtr
- CNG Filling Valve NGV/NZS
- Pressure Gauge 5V
- Injector Rail Lowgas
- Fitting Accessories
- Rubber Hoses 5mm for Gas and Vacuum, 11mm for Gas
- ECU Kit - MP32
- Filter 360°
- CNG Cylinder Valve

CNG SEQUENTIAL KIT 4C-48

- CNG Reducer Model S9000/S8000/S7000
- CNG High Pressure Steel Pipe 6mm x 5.5 mtr
- CNG Filling Valve NGV/NZS
- Pressure Gauge 5V
- Injector Rail Lowgas
- Fitting Accessories
- Rubber Hoses 5mm for Gas and Vacuum, 11mm for Gas
- ECU Kit - MP48
- Filter 360°
- CNG Cylinder Valve





CNG KIT-CARS



CNG SEQUENTIAL KIT 6C-8C

- CNG Reducer Model S9000/S8000/S7000
- CNG High Pressure Steel Pipe 6mm x 5.5 mtr
- CNG Filling Valve NGV/NZS
- Pressure Gauge 5V
- Injector Rail Lowgas
- Fitting Accessories
- Rubber Hoses 5mm for Gas and Vacuum, 11mm for Gas
- ECU Kit - MP6C-8C
- Filter 360°
- CNG Cylinder Valve

CNG CONVENTIONAL KIT

- CNG Reducer Model R01
- CNG High Pressure Steel Pipe 6mm x 5.5 mtr
- CNG Filling Valve NGV/NZS
- Pressure Gauge 5V
- Air Gas Mixer (Optional)
- Fitting Accessories
- Rubber Hoses 19mm for Gas
- Change Over Switch 231
- CNG Cylinder Valve





CNG KIT-3 WHEELER



CNG CONVENTIONAL KIT

- CNG Reducer Model R01
- CNG High Pressure Steel Pipe 6mm x 5.5 mtr
- CNG Filling Valve NGV/NZS
- Pressure Gauge 5V
- Air Gas Mixer (Optional)
- Fitting Accessories
- Rubber Hoses 19mm, 11mm for Gas
- Change Over Switch 222
- Petrol Solenoid Valve
- CNG Cylinder Valve



LPG KIT-3 WHEELER

CNG SEQUENTIAL KIT 4C-48

- LPG Vaporizer Reducer Model P2000/E3000
- LPG High Pressure Pipe 1.5 mtr
- Multifunction Valve
- Filling Valve
- Level Sensor
- Fitting Accessories
- Rubber Hoses 5mm, 10mm
- Change Over Switch Model 222
- Petrol Solenoid Valve
- Air Gas Mixer





LPG KIT-CARS



LPG SEQUENTIAL KIT 4C-32

- LPG Reducer Model S5000/S5000-SUPER
- LPG High Pressure Copper Pipe 6mm x 5.5 mtr
- Pigtail Hose 8mm
- LPG Filling Valve
- Level Sensor
- Injector Rail Lowgas
- Fitting Accessories
- Rubber Hoses 5mm for Gas and Vacuum, 11mm for Gas, 7.5mm/16mm for coolant
- ECU Kit - MP32
- Filter 360°
- Multi Function Valve
- Vapor Box

LPG SEQUENTIAL KIT 4C-48

- LPG Reducer Model S5000/S5000-SUPER
- LPG High Pressure Copper Pipe 6mm x 5.5 mtr
- Pigtail Hose 8mm
- LPG Filling Valve
- Level Sensor
- Injector Rail Lowgas
- Fitting Accessories
- Rubber Hoses 5mm for Gas and Vacuum, 11mm for Gas, 7.5mm/16mm for coolant
- ECU Kit - MP48
- Filter 360°





LPG KIT-CARS



LPG SEQUENTIAL KIT 6C-8C

- LPG Reducer Model S5000-SUPER
- LPG High Pressure Copper Pipe 6mm x 5.5 mtr
- Pigtail Hose 8mm
- LPG Filling Valve
- Level Sensor
- Injector Rail Lowgas
- Fitting Accessories
- Rubber Hoses 5mm for Gas and Vacuum, 11mm for Gas, 7.5mm/16mm for coolant
- ECU Kit - MP32
- Filter 360°
- Multi Function Valve
- Vapor Box

LPG CONVENTIONAL KIT

- LPG Reducer Model E2000
- LPG High Pressure Copper Pipe 6mm x 5.5 mtr
- Pigtail Hose 8mm
- LPG Filling Valve
- Level Sensor
- Fitting Accessories
- Rubber Hoses 19mm, 11mm for Gas, 7.5mm/16mm for coolant
- Change Over Switch Model 221
- Emulator 4C
- Multi Function Valve
- Vapor Box





CNG REDUCER

The pressure regulator is designed and dedicated for CNG Sequential Injection Systems. It can be installed in most of the Cars. The Reducer is supplied with a sensitive 1st stage reduction system that warrants stable pressure value in spite of pressure variation from the tank. Thanks to its efficient two stage Gas flow control system it ensures the most optimal GAS dosage in any drive conditions.

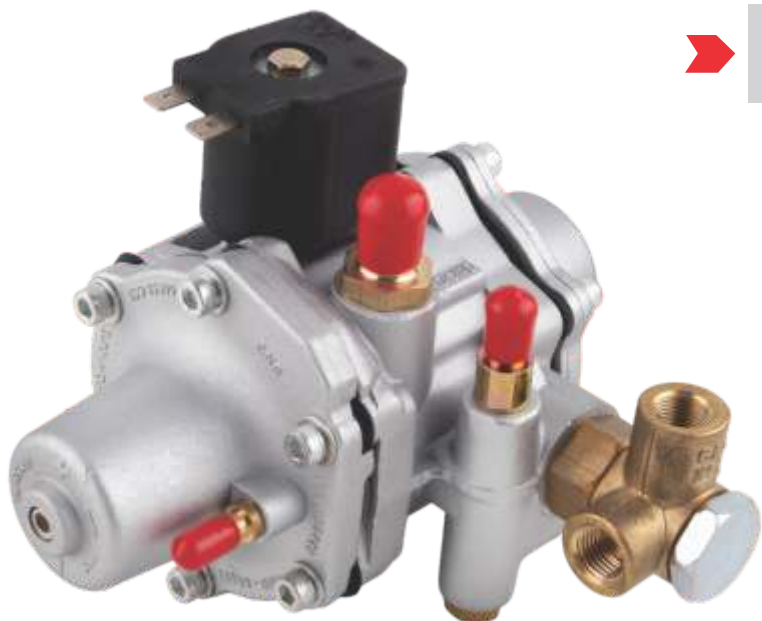

CNG SEQUENTIAL REDUCER Model: S9000

Material	Die Cast Aluminium Body
Weight	1.43 Kg
Dimensions	143x126x154 mm
Max. Inlet Pressure	260 Bar
Outlet Pressure	Adjustable from 1.60 till 2.20 Bar
Solenoid Voltage	12V DC
Coil Power Consumption	17W
Inlet Connection	ø6 mm Pipe, M 12x1
Outlet Connection	ø12 mm
Engine Power	140kW

CNG SEQUENTIAL REDUCER Model: S8000

Material	Die Cast Aluminium Body
Weight	1.43 Kg
Dimensions	143x126x154 mm
Max. Inlet Pressure	260 Bar
Outlet Pressure	Adjustable from 1.60 till 2.20 Bar
Solenoid Voltage	12V DC
Coil Power Consumption	17W
Inlet Connection	ø6 mm Pipe, M 12x1
Outlet Connection	ø12 mm
Engine Power	140kW

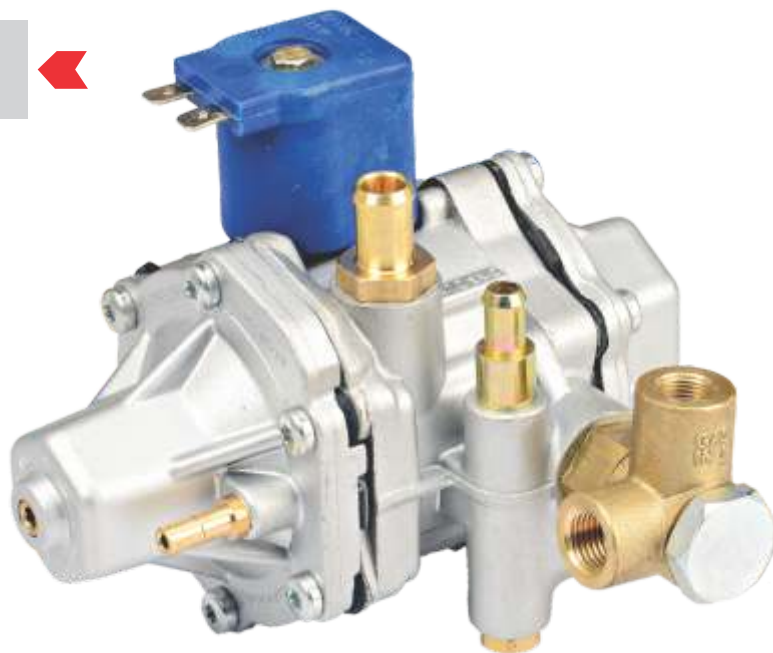



CNG REDUCER

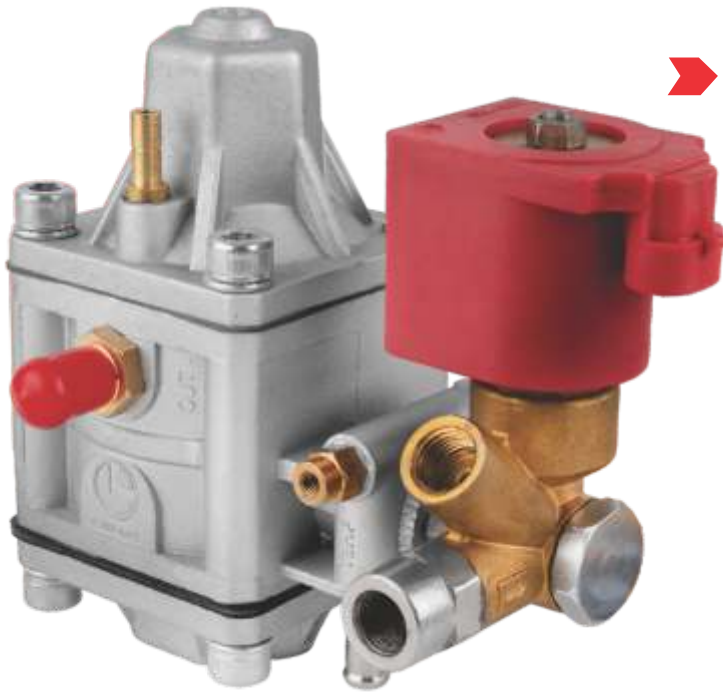

CNG SEQUENTIAL REDUCER Model: S7000

Material	Die Cast Aluminium Body
Weight	1.43 Kg
Dimensions	143x126x154 mm
Max. Inlet Pressure	260 Bar
Outlet Pressure	Adjustable from 1.60 till 2.20 Bar
Solenoid Voltage	12V DC
Coil Power Consumption	17W
Inlet Connection	ø6 mm Pipe, M 12×1
Outlet Connection	ø12 mm
Engine Power	140kW

CNG CONVENTIONAL REDUCER Model: R01

Material	Die Cast Aluminium Body
Weight	2.10 Kg
Dimensions	210x125x165 mm
Max. Inlet Pressure	260 Bar
Outlet Pressure	0.80 Bar
Solenoid Voltage	12V DC
Coil Power Consumption	17W
Inlet Connection	ø6 mm Pipe, M 12×1
Outlet Connection	ø19 mm
Engine Power	upto 140 HP





CNG VALVES

LowGas CNG Manual Vented Cylinder Valve is provided with manual tap and can be equipped both with excess flow valve and integrated or separated safety devices. The valve is supplied with rubber protection for cylinder thread (for ventilation). Important: this type of valves does not need the gas-tight housing.



CNG CYLINDER VALVE Model: CV01

Material	Hot forged brass CNC machined
Weight	0.70 kg
Type of product	Vented CNG manual valve
Max. working pressure	26.0 MPa
Working temperature	-40°C / 85°C
T-PRD activation temperature	+108 °C ± 6 °C
Burst pressure (T 20°C)	34 MPa ± 10% *
Opening/closing angle	90° (270° upon request)
Pipe connection *	M12x1 pipe Ø 6 mm
Cylinder thread	DIN (25E), upon request BS, NGT

CNG FILLING VALVE Model: NZS01

CNG filling valves are used to fill high-pressure natural gas from CNG Filling station to the Cylinder. These valves are equipped with Non-return Valve, so Gas doesn't vent from filling point. Manual Tap is installed to close the flow to reducer for servicing.

Dimensions	80x34x76 mm
Max Working Pressure	260 Bar
Max Working Temperature	-40°C to + 120°C
Weight	0.45 Kg
Filling Unit type	New Zealand Standard





CNG VALVES



CNG FILLING VALVE Model: NGV01

CNG filling valves are used to fill high-pressure natural gas from CNG Filling station to the Cylinder. These valves are equipped with Non-return Valve, so Gas doesn't vent from filling point. Manual Tap is installed to close the flow to reducer for servicing.

Dimensions	89x34x76 mm
Max Working Pressure	260 Bar
Max Working Temperature	-40°C to + 120°C
Weight	0.40 Kg
Filling Unit type	NGV

CNG FILLING VALVES Model: NGV02

CNG filling valves are used to fill high-pressure natural gas from CNG Filling station to the Cylinder. These valves are equipped with Non-return Valve, so Gas doesn't vent from filling point.

Dimensions	80x25x25mm
Max Working Pressure	260 Bar
Max Working Temperature	-40°C to + 120°C
Weight	200g
Filling Unit type	NGV





CNG FILLING VALVE Model: NGV03

CNG filling valves are used to fill high-pressure natural gas from CNG Filling station to the Cylinder. These valves are equipped with Non-return Valve, so Gas doesn't vent from filling point.

Dimensions	80x80x80mm
Max Working Pressure	260 Bar
Max Working Temperature	-40°C to + 120°C
Weight	0.40 Kg
Filling Unit type	NGV



CNG FILLING VALVES Model: NZS02

CNG filling valves are used to fill high-pressure natural gas from CNG Filling station to the Cylinder. These valves are equipped with Non-return Valve, so Gas doesn't vent from filling point.

Manual Tap is installed to close the flow to reducer for servicing.

Dimensions	80x35x76mm
Max Working Pressure	260 Bar
Max Working Temperature	-40°C to + 120°C
Weight	500g
Filling Unit type	New Zealand Standard

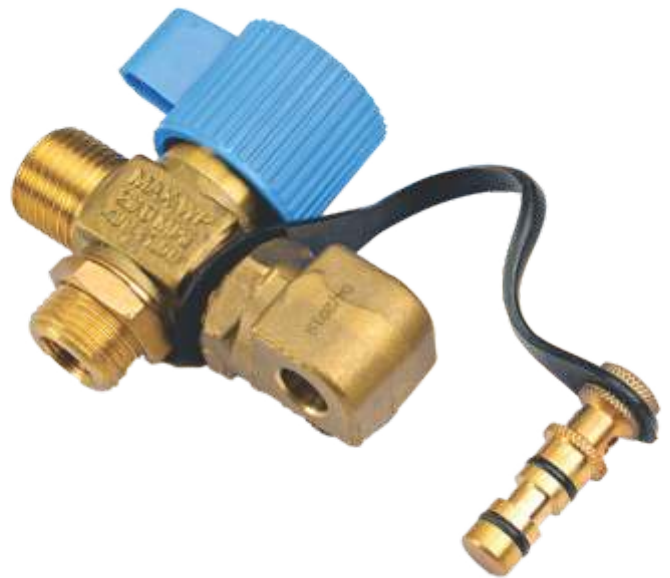



LPG VAPORIZER



LPG SEQUENTIAL VAPORIZER Model: S5000

Material	Die Cast Aluminium Body
Weight	1.40 kg
Dimensions	120x125x105 mm
Max. Inlet Pressure	30 Bar
Outlet Pressure	Adjustable from 0.8 till 1.5 Bar
Solenoid Voltage	12 V DC
Coil Power Consumption	17W
Inlet Connection	ø6 mm pipe, M 10×1
Outlet Connection	ø12 mm, ø10 mm,
Engine Power	Upto 100 HP

LPG SEQUENTIAL VAPORIZER Model: S5000 SUPER

Material	Die Cast Aluminium Body
Weight	1.55 kg
Dimensions	149x161x124 mm
Max. Inlet Pressure	30 Bar
Outlet Pressure	Adjustable from 0.8 till 1.60 Bar
Solenoid Voltage	12 V DC
Coil Power Consumption	17W
Inlet Connection	ø6 mm pipe, M 10×1
Outlet Connection	ø12 mm
Engine Power	Upto 140 HP





LPG VAPORIZER

It is a two stage reducer which reduces the LPG pressure and vaporize it allowing the regular flow of gas to the engine. The phase of gas is changed from liquid to gas by reducing pressure and absorption of heat from the body of the reducer which is heated by the liquid of the engine cooling circuit. Flow of gas is maintained through intake manifold pressure generated by the engine. Thanks to its sensitivity membrane and its reliability, the reducer guarantees a perfect driving pleasure.



LPG ELECTRONIC VAPORIZER Model: E2000

Material	Die Cast Aluminium Body
Weight	1.90 kg
Dimensions	195x201x118 mm
Max. Inlet Pressure	30 Bar
Inlet Connection	ø6 mm pipe, M 10×1
Outlet Connection	ø18 mm
Engine Power	E2000 - Upto 140 HP

LPG ELECTRONIC VAPORIZER Model: E3000

It has a built-in gas valve with filter for the liquid phase. Does not require the installation of additional gas valve

Material	Die Cast Aluminium Body
Weight	1.80 kg
Dimensions	195x150x115 mm
Max. Inlet Pressure	30 Bar
Inlet Connection	ø6 mm pipe, M 10×1
Outlet Connection	ø18 mm
Engine Power	E3000 - Upto 140 HP





LPG VAPORIZER



LPG VACUUM VAPORIZER Model: P2000

Material	Die Cast Aluminium Body
Weight	1.90 kg
Dimensions	195x 180 x125 mm
Max. Inlet Pressure	30 Bar
Inlet Connection	ø6 mm pipe, M 10×1
Outlet Connection	ø18 mm
Engine Power	P2000 - Upto 140 HP

LPG MOTO VAPORIZER Model: P1000

Material	Die Cast Aluminium Body
Weight	0.700 kg
Dimensions	150x 150x100 mm
Max. Inlet Pressure	0.3 Bar
Inlet Connection	Ø7.5 mm Low Pressure Hose
Outlet Connection	Ø5mm Low Pressure Hose
Engine Power	P1000 - Upto 14 HP





INJECTORS

LPG/CNG Injection Rail, gaseous fuel injectors with 0,45 MPa max working pressure. Available with different resistance coils, AMP superseal incorporated connector. The injectors are available in different versions with 3 and 4 cylinders, with gas INLET option for both side of the rail by mean of hose connector with diameter 11mm, 12 mm.

INJECTOR RAIL Model: IR04

Coil Resistance	2 OHM / 3 OHM
Opening Time (+ 5%)	3.0 ms / 3.2 ms
Closing Time (+ 5%)	2.5 ms / 2.7 ms
Material	Aluminium
Maximum Working Pressure	0.45 MPa
Supply Voltage	11 - 14.4V
Inlet Gas Fitting	11mm/12mm
Outlet Gas Fitting	Calibrated Nozzles M6 X 1
Temp. Range for CNG	-40 C to + 120 C
Temp. Range for LPG	-20 C to + 120 C
Dimensions	151x46x62
Weight	480g
Available in	3 and 4 Injector Sets.

COPPER PIPES

Copper pipe with Black PVC Coating

Max working pressure: 30 bar

Size: OD 6mm, 8mm

Length - As per requirement

Max working temperature: -25°C +65°C

Application: LPG AUTOGAS

Certification: ICAT





LPG VALVES

This device is used to cut off flow of LPG when the vehicle is running on Petrol mode. It is fitted between MultiValve and Reducer.



LPG GAS SOLENOID VALVE Model: BGV01

Material	Brass Forge Body and Aluminum Die Cast Cup
Max. Working Pressure	30 Bar
Solenoid Voltage	12 V DC,
Inlet/Outlet Connection	M 10×1 for 6×1 Pipes
Filtering Capability	Felt 10 Micron
Working Temperature	-20°C to +120°C
Coil Power Consumption	11W
Dimensions	65x49x101 mm
Weight	0.350 Kg

LPG GAS SOLENOID VALVE Model: BGV02

Material	Aluminum Die Cast Body
Max. Working Pressure	30 Bar
Solenoid Voltage	12 V DC,
Inlet/Outlet Connection	M 10×1 for 6×1 Pipes
Filtering Capability	Steel Mesh 50 Micron
Working Temperature	-20°C to +120°C
Coil Power Consumption	11W
Dimensions	65x49x101 mm
Weight	0.250 Kg





LPG VALVES



LPG GAS SOLENOID VALVE Model: BGV03

Material	Brass Forge Body
Max. Working Pressure	30 Bar
Solenoid Voltage	12 V DC,
Inlet/Outlet Connection	M 10×1 for 6×1 Pipes
Filtering Capability	Paper Filter
Working Temperature	-20°C to +120°C
Coil Power Consumption	11W
Dimensions	65x49x101 mm
Weight	0.350 Kg

LPG GAS SOLENOID VALVE Model: BGV04

Material	Brass Forge Body
Max. Working Pressure	30 Bar
Solenoid Voltage	12 V DC,
Inlet/Outlet Connection	M 10×1 for 6×1 Pipes
Filtering Capability	Paper Filter
Working Temperature	-20°C to +120°C
Coil Power Consumption	11W
Dimensions	65x49x101 mm
Weight	0.360 Kg





LPG VALVES



LPG GAS SOLENOID VALVE Model: BGV05

Material	Brass Forge Body
Max. Working Pressure	30 Bar
Solenoid Voltage	12 V DC,
Inlet/Outlet Connection	M 10×1 for 6×1 Pipes
Filtering Capability	Paper Filter
Working Temperature	-20°C to +120°C
Coil Power Consumption	11W
Dimensions	65x49x101 mm
Weight	0.450 Kg

PETROL SOLENOID VALVE Model: ZPV002

Kind of Fuel	Gasoline
Function flow	Close / Open of Gasoline
Body	Brass / MS
Work Pressure	2 Bar
Passage Section	12,6 mm ² (ø4 mm)
Electric Feeding	12 V DC
Electric Power	11 W
Dimensions	87×64.5×63 mm
Weight	0.22 Kg

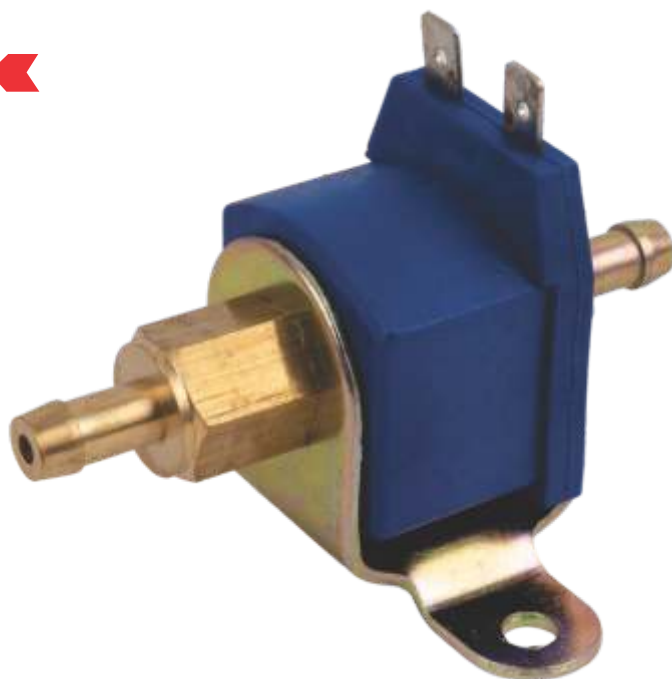



PETROL SOLENOID VALVE Model: ZPV003

Kind of Fuel	Gasoline
Function	Close / Open of Gasoline flow
Body	Brass / Aluminum
Work Pressure	2 Bar
Passage Section	12,6 mm ² (ø4 mm)
Electric Feeding	12 V DC
Electric Power	11 W
Dimensions	65×40×63 mm
Weight	0.15 Kg

LPG FILLING VALVE Model: FV002 WITH COVER

A solid and durable filling Valve Italian Dish Type design, is made from high quality modified forged Brass. It guarantees a very tight and hermetic connection between filling point pistol and copper or thermoplastic pipe, bringing gas to the tank in a safe and efficient way. It is equipped with specially designed NRV to prevent return flow of Gas from TANK to Environment. 100% Leak Tested.





LPG VALVES

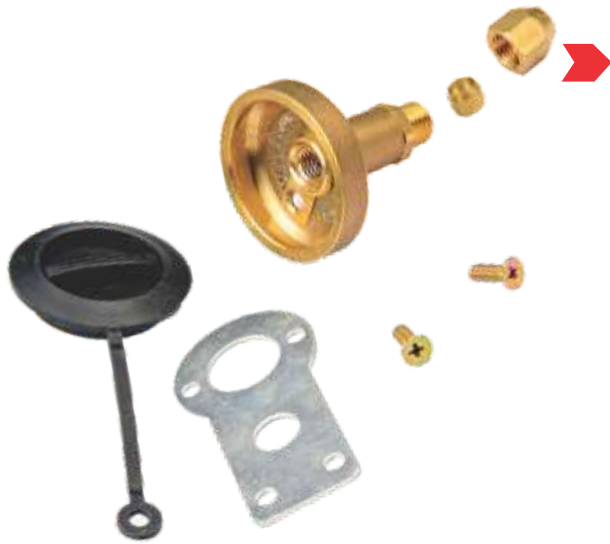

LPG FILLING VALVE Model: FV002

A solid and durable filling Valve Italian Dish Type design, is made from high quality modified forged Brass. It guarantees a very tight and hermetic connection between filling point pistol and copper or thermoplastic pipe, bringing gas to the tank in a safe and efficient way. It is equipped with specially designed NRV to prevent return flow of Gas from TANK to Environment. 100% Leak Tested.

LPG FILLING VALVE Model: FV003

Filling Valve for Mounting in Petrol Filling Cap Cover.
Option Available for Thermoplastic Hose Fittings

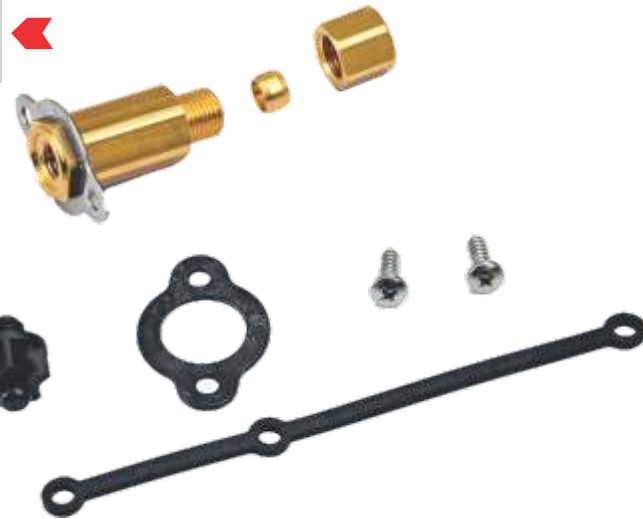

LPG FILLING VALVE Model: FV003 +FA001

Filling Valve for Mounting in Petrol Filling Cap Cover.
Option Available for Thermoplastic Hose Fittings. Along
with Dish Type Adaptor .





MULTIFUNCTION VALVE



LPG MULTIFUNCTION VALVE Model: ZMV31530



LOWGAS multifunction valve is designated for LPG tanks and has been designed in accordance with the European Regulation ECE 67R01. This multifunction valve is equipped with many safety devices such as: pressure relief valve, 80% filling limiter, excess flow valve, non-return valve, manual (service) valve, mechanical level indicator.

LPG MULTIFUNCTION VALVE Model: ZMV31590

Material	Hot forged brass
Weight	1.00 kg
PRV setting	2.7 MPa (27 bar)
PRV flow rate	23.4 Nm ³ /min
Filling speed	18 lt/min @ 10 bar
Inlet connection	1/4 BSP/8mm
Outlet connection	M10x1/pipe Ø6 mm or M12x1/pipe Ø8 mm
Automatic 80% level stop	Yes



LPG MULTIFUNCTION VALVE Model: ZMVT180/200/225/250



Available for Cylindrical and Toroidal Tanks in 180, 200, 270, 300, 315, 360 diameter and 0, 30, 90 degree installation.



FILTERS



GAS FILTER 360 **Model: GF001**

LPG/CNG Filter 360 with replaceable Cartridge Filter 46mm length

LPG and CNG dry gas filter with paper cartridge/ polyester Cartridge or Glass Fiber Cartridge.

Housing material PA66 Glass Filled

Inlet diameter \varnothing 12 mm

Outlet diameter \varnothing 12 mm

Filtration material Paper/Polyester

Flow Capacity 25 l/s

GAS FILTER INSERT **Model: GFI001**

LPG/CNG Filter 360 with replaceable Cartridge Filter 46mm length

LPG and CNG dry gas filter with paper cartridge/ polyester Cartridge or Glass Fiber Cartridge.

Filtration material Paper/Polyester

Flow Capacity 25 l/s



GAS FILTER **Model: GF002**

In line filter for gaseous phase. Not replaceable filter cartridge

Available in following sizes: 12x12, 14x14, 16x16 mm



ELECTRONIC CONTROL UNIT Model: MP32

ECU KIT Consists of: ECU 32 Pin Switch with horn signal and level indicator. PT-MAP sensor. Harness with waterproof plugs. Waterproof fuse box Waterproof 32-pin harness connector for connection with the unit. Suitable with 2/3/4 cylinder engines Lightweight, shock-resistant, plastic housing Intelligent ECU with lots of options Extended calibration card: 12×12 fields Automatic correction of the calibration map. Gas injectors heating. Gas injectors diagnostics.

The ability to display the oscilloscope in a separate window of the monitor screen

MP32 ECU KIT made by AEB Italy. Will open in DIGITRONIC or MOTOZEN Software.

ELECTRONIC CONTROL UNIT Model: M48

Lightweight, shock-resistant, plastic housing Intelligent ECU with lots of options

Extended calibration card: 12×12 fields Automatic correction of the calibration map Gas injectors heating

Gas injectors diagnostics Waterproof 48-pin harness connector for connection with the unit The ability to display the oscilloscope in a separate window of the monitor screen The "Valve protection" option Advancing the injection phase Active diagnostics of installed components Petrol injectors diagnostics in real time.



ELECTRONIC CONTROL UNIT Model: 6C/8C

MP6C ECU has been designed for 5-6 -cylinder timed sequential multipoint injection vehicles. While running on gas, the MP6C reads fuel injection timing and gas temperature pressure and calculates the e Gas quantity that has to be injected in gaseous form in the intake manifold to obtain the same performance the vehicle would offer when running on petrol. Thanks to the OBD communication protocol, the MP6C reads some original ECU parameters for better adapting the system and compensate the drifts and aging of the mechanical components of the Gas system.



CHANGE OVER SWITCH Model: ZSC0231

Change Over Switch for MPFI Engines, Car will start on Petrol and Switch to Gas on Acceleration, which can be adjusted with Preset Provided. Level Indicator suitable for LPG Gauge 1050 or CNG 806



EMULATOR Model: ZE224-J

Emulators are electronic devices that simulate several original vehicle signals that have to be interrupted or altered during gas operation (petrol injectors, Lambda probe, MAP, etc). Their use prevents the original control unit of the vehicle from detecting false malfunctions due to the fact that the engine is not running on petrol, and consequently prevents the "check engine" light on unwarrantedly. The emulator model appropriate for each vehicle varies according to the type of original injection system.



TIMING ADVANCE PROCESSOR Model: ZTA001

Timing advance processors are electronic control units that change the original spark advance of the engine when it runs on CNG or LPG thus optimising the engine's operation with these fuels.





WHY US?



OUR MOTTO:

We work hard to offer best quality product at most economical price



DIVERSE EXPERIENCE:

Our Company is promoted by Engineers & technocrats with 25 years of experience in alternate fuel & energy



INTERNATIONAL QUALITY:

Our products meet and exceeds most of the international standards -E67, E110R, ISO15500



UNIVERSAL SPARE PARTS:

We offer economical & state of the art repair kits, filters, diaphragms and other spare parts as per customer drawings and international standards



LOWGAS[®]

DRIVE CLEAN - DRIVE GREEN



CLEAN ENVIRO FUELS PVT. LTD.

Plot No: 231, Sector 8, IMT Manesar,
Gurgaon 122052, Haryana, INDIA

Phone: +91 9810 185 539

Email: info@lowgas.in | jogeshverma@hotmail.com

Website: www.lowgas.in